



PrimaVision Mini for CDM

HID-PV m 20 /S CDM 220-240V 50/60Hz

Miniature HID electronic gear for PGJ5 CDM lamps – freeing up the boundaries of creativity and innovation in luminaire design

Product data

| General information | |
|--|--------------|
| Application Code | HPF |
| Type Version | mk2 |
| Lamp Type | CDM |
| Number of Lamps | 1 piece/unit |
| Suitable For Outdoor Use | No |
| Number of Products on MCB (16A Type B) (Nom) | 32 |
| Automatic Restart | Yes |
| Operating and electrical | |
| Input Voltage | 220 to 240 V |
| Input Frequency | 50 to 60 Hz |
| Minimum Mains Voltage Operation (Min) | 198 V |
| Power Factor 100% Load (Nom) | 0.95 |
| Ignition Voltage (Max) | 4.5 kV |
| Ignition Voltage (Min) | 3.3 kV |
| Ignition Switch-Off Time (Nom) | 21 min |
| Mains Voltage Performance (AC) | 198-254V |
| Mains Voltage Safety (AC) | 180-264V |
| Earth Leakage Current (Max) | 0.5 mA |
| Inrush Current Width | 0.25 ms |

| Constant Wattage Deviation | -3%/+3% |
|--|---------------------------|
| Power Losses (Nom) | 3.5 W |
| Inrush Current Peak (Max) | 15 A |
| Efficiency at full load [%] | 81.6 % |
| Wiring | |
| Cable Capacity Output Wires Mutual (Nom) | 50 pF |
| Cable Length From Device to Lamp | 0.5 m |
| Wire Striplength | 8.5-9.5 mm |
| Ballast Contact Wire Cross Section | 0.75-1.50 mm ² |
| Connector Type | Insert |
| System characteristics | |
| Rated Ballast-Lamp Power | 20 W |
| Temperature | |
| T-Ambient (Max) | 55 °C |
| T-Ambient (Min) | -20 °C |
| T-Storage (Max) | 80 °C |
| T-Storage (Min) | -25 °C |
| T-Case Lifetime (Nom) | 80 °C |

PrimaVision Mini for CDM

| | |
|---------------------------------|---|
| T-Case Maximum (Max) | 80 °C |
| Mechanical and housing | |
| Housing | /S |
| Approval and application | |
| Active Temperature Protection | Yes |
| EMI 9 kHz ... 300 MHz | CISPR 15 ed 7.2 / 2009 |
| Vibration Standard | IEC68-2-6 F c |
| Bumps Standard | IEC 68-2-29 Eb |
| Approval Marks | CE marking ENEC certificate VDE certificate |
| Hum And Noise Level | < 25 dB(A) |

Product data

| | |
|---------------------------------|-------------------------------------|
| Full product code | 871829167159600 |
| Order product name | HID-PV m 20 /S CDM 220-240V 50/60Hz |
| EAN/UPC - Product | 8718291671596 |
| Order code | 913700696066 |
| Numerator - Quantity Per Pack | 1 |
| Local code description | REATOR ELETRONICO HID-PV020SMCDM |
| Numerator - Packs per outer box | 12 |
| Material Nr. (12NC) | 913700696066 |
| Net Weight (Piece) | 0.115 kg |

Dimensional drawing

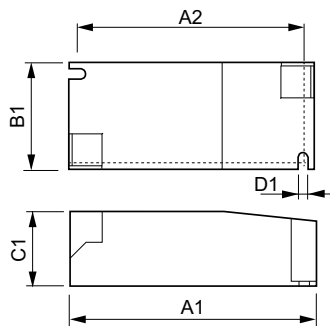

HID-PV m 20 /S CDM 220-240V 50/60Hz

| Product | D1 | C1 | A1 | A2 | B1 |
|-------------------------------------|--------|---------|---------|---------|---------|
| HID-PV m 20 /S CDM 220-240V 50/60Hz | 4.2 mm | 30.2 mm | 97.3 mm | 88.3 mm | 43.3 mm |

